

PLOT FOR SALE
THE OLD MALT BARNs,
SOUTH QUEENSFERRY



Plot of land with full planning permission for two large flats, two townhouses or one single dwellinghouse (6,000 sq ft). Site adjoins picturesque old harbour with views of bridges and across Forth to Fife.

THE OLD MALT BARNs, SOUTH QUEENSFERRY

DESCRIPTION

The Old Malt Barns consists of a plot of ground adjoining the picturesque South Queensferry old harbour with views of the bridges and across the Forth to Fife and beyond. There is full planning permission for two large flats, two townhouses or one large single dwellinghouse (6,000 sq ft). Access is gained from historic South Queensferry High Street.

PLANNING

Full planning permission for residential use (plans available) was granted by Edinburgh District Council for the flats or townhouses on 16 December 1992 (application no A0234492FFAS). Details of permission for the single dwellinghouse are also available on request.

PRESENT USE

The plot is currently unused and immediate commencement is possible subject to the correct building warrants.

SITUATION

The proposed access point is between the charity shop and the Stag's Head Bar on South Queensferry High Street. To view the site, travel down the lane to the left hand side of the Stag's Head with the plot being on your right hand side.

For further information, please contact Slater Hogg & Howison, Corstorphine office on 031 316 4455.

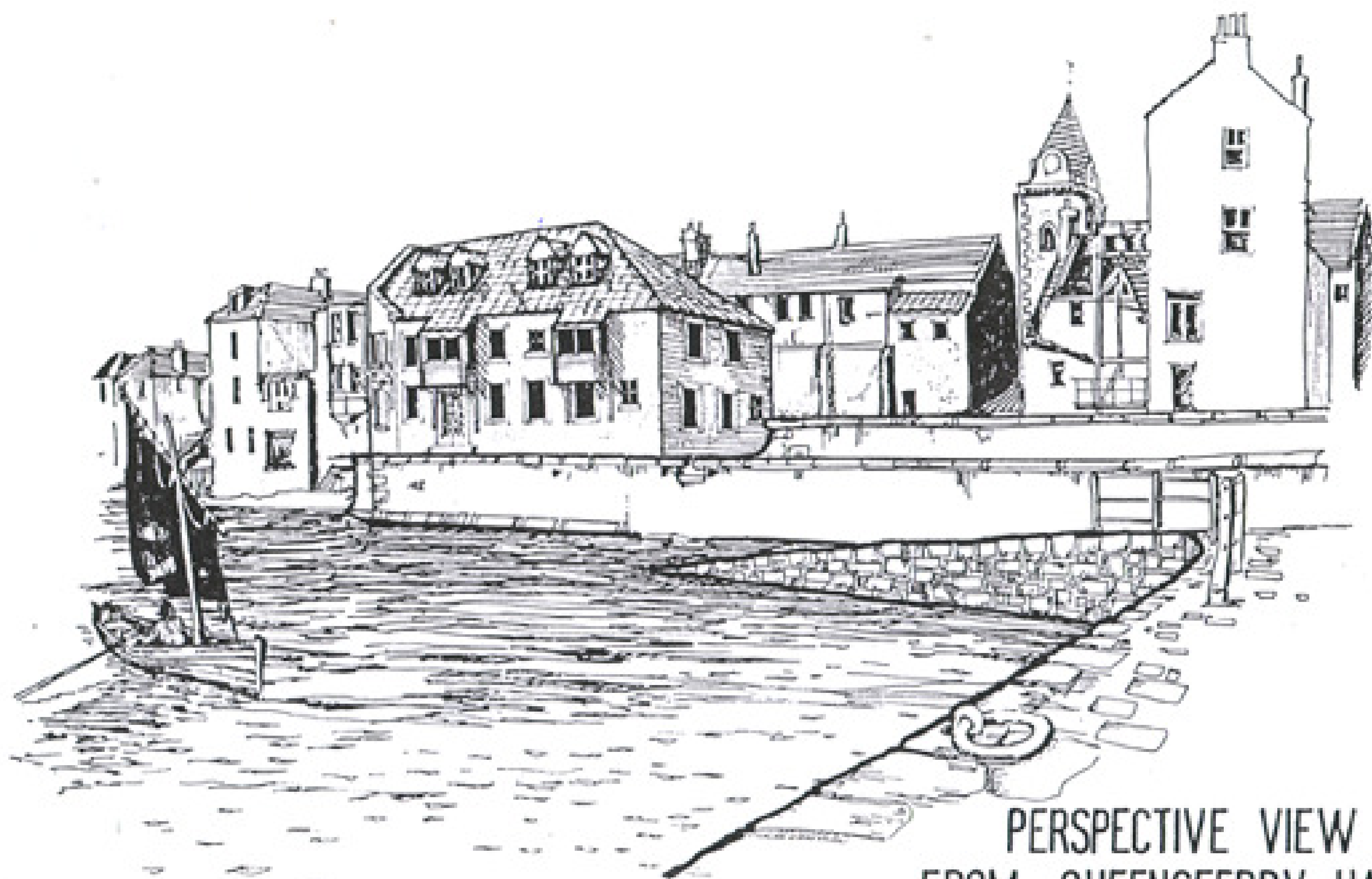

PERSPECTIVE VIEW
 FROM QUEENSFERRY HARBOUR.
 2 FLATS or 2 TOWN HOUSES

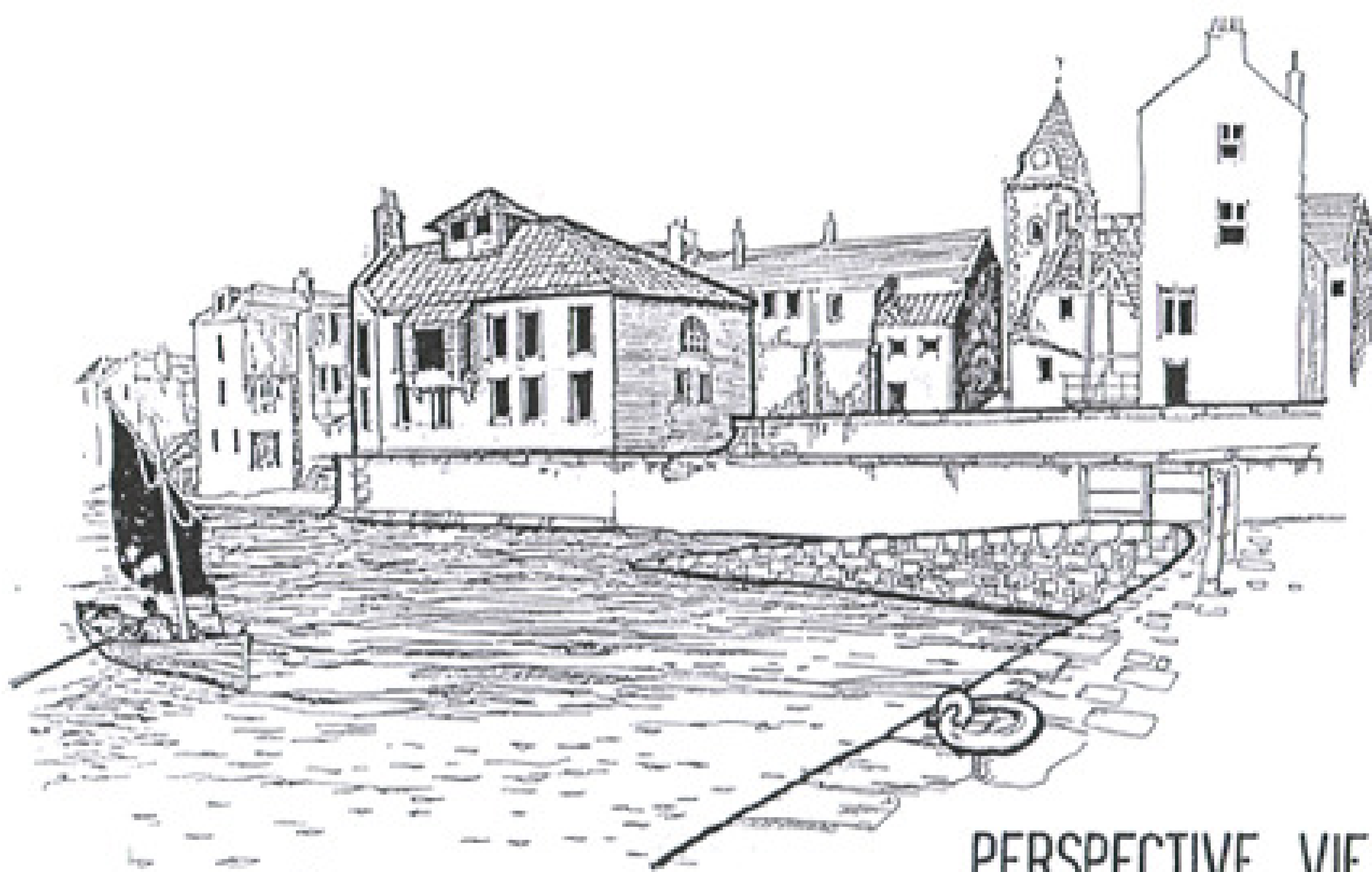

PERSPECTIVE VIEW
 FROM QUEENSFERRY HARBOUR

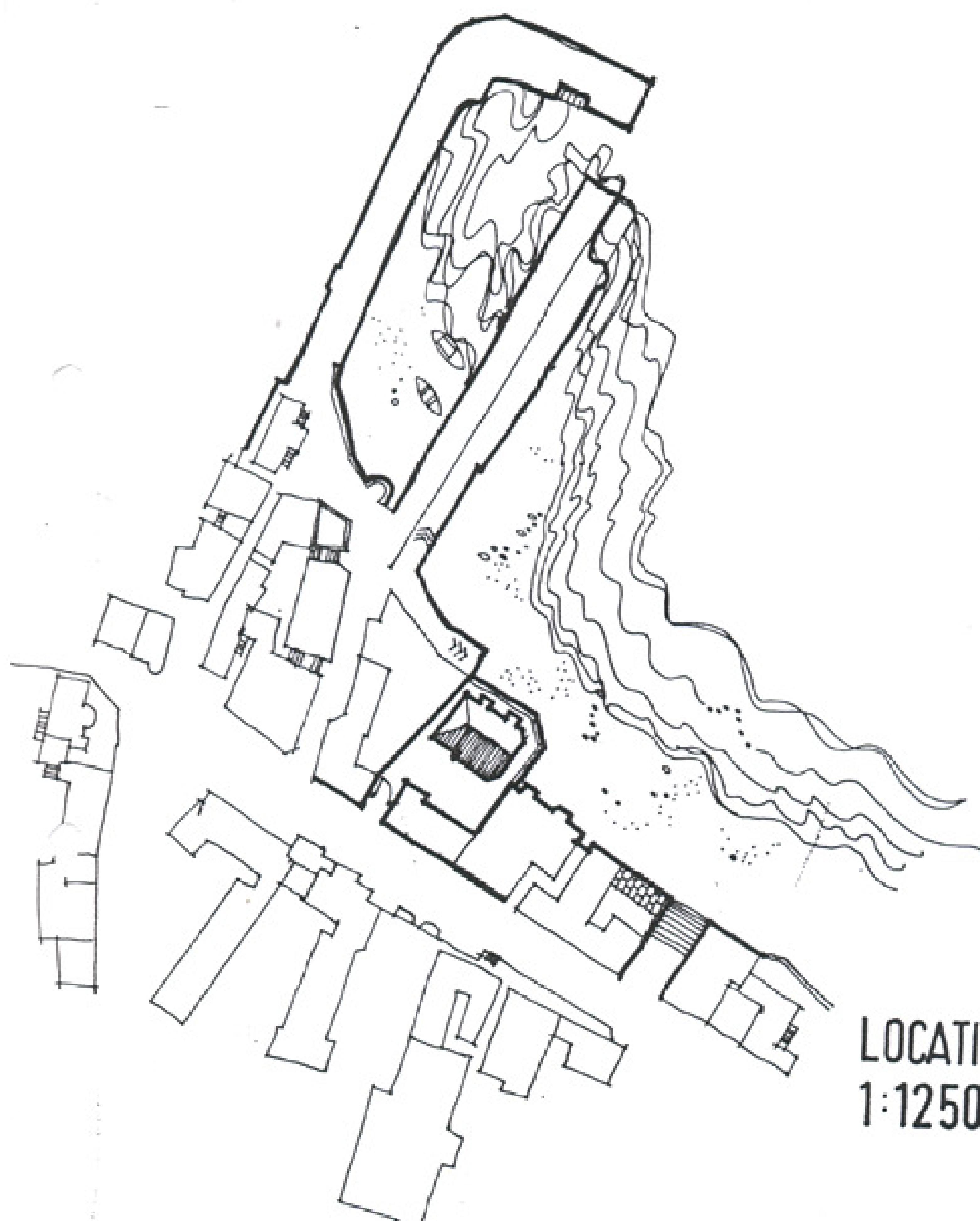

LOCATION PLAN
 1:1250 North